

Workshop Program

- 0900: Introductions
- 0915: Guest Speaker
Therese Sanderson
- 1000: What is Evaluation/Assessment?
- 1030: Morning tea
- 1100: Group activity
- 1130: Difficult and positive
Elements of Evaluation
- 1200: Discussion on how to
address each of these issues.
- 1300: Lunch
- 1400: The SMART Process
- 1500: Applying the SMART Process
- 1600: End of Workshop

1630: ANTSNSW AGM
1730: Meeting Closed

Evaluation & Assessment of Students and Peers

Date: 5th November, 2011

Time: 0900hrs – 1600hrs

Location: University of Newcastle
Ring Road off University Drive

RW 2-30 Second Floor,
School of Nursing & Midwifery

Cost: \$40 members \$65 non members

Annual General Meeting of ANTSNSW

will follow the workshop

1630hrs – 1730hrs

Yes, I will be attending the
workshop

Name:

Address:

Email:

Contact phone number:

Special Dietary Needs:

Payment Details:

Member: \$40 Non Member: \$60

Payment Type:

Cheque: MasterCard: Visa:

Card Number:

Expiry Date:/.....

Amount: \$

Cardholder's Name:

Signature:

University of Newcastle Campus

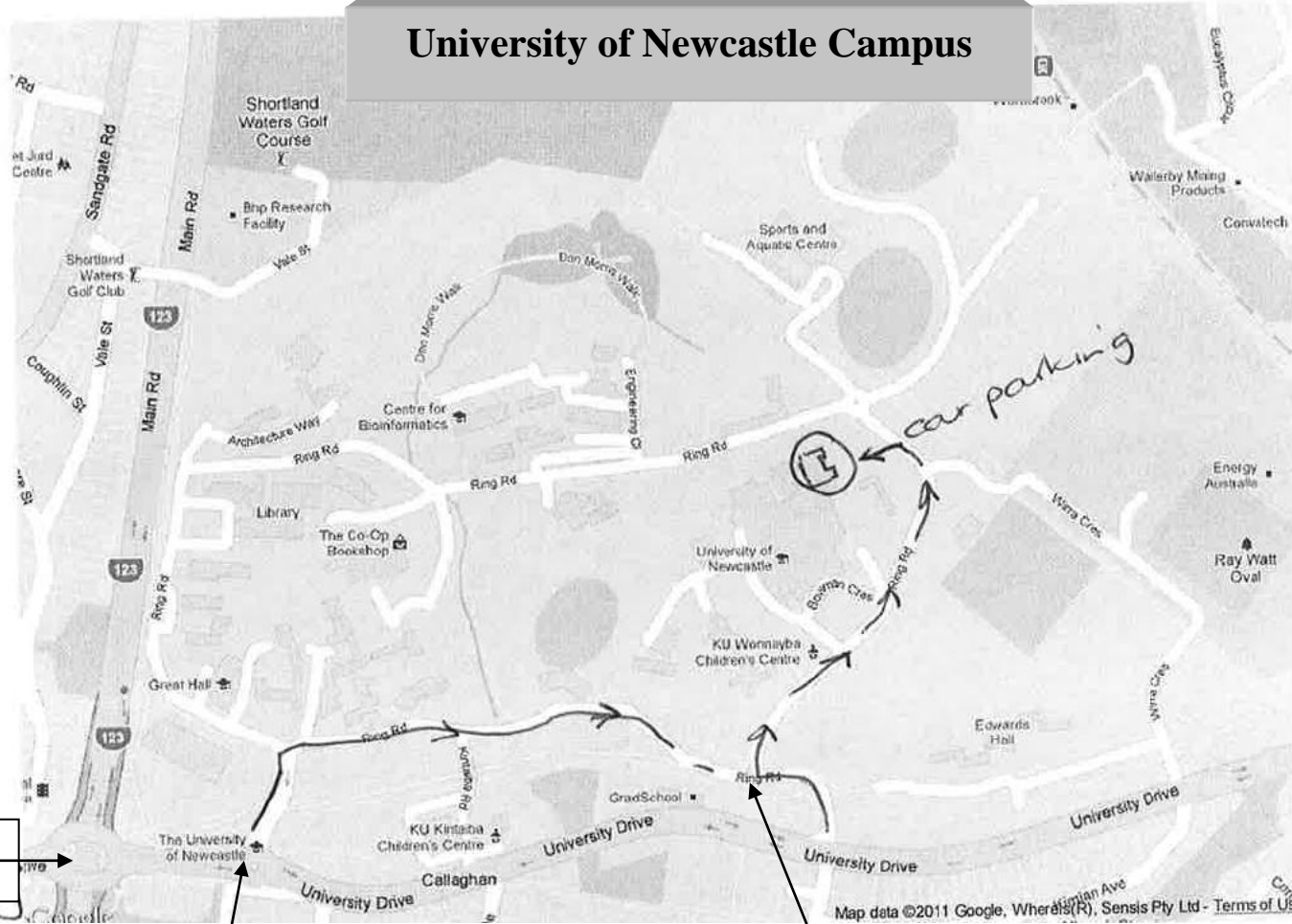

From Sydney

Entrance into Ring Road (L)
@ Roundabout

Entrance into Ring Road
Left @ Lights

Car Park

Entrance via Door
& go up the Stair
Turn (R) at Top of
First Door

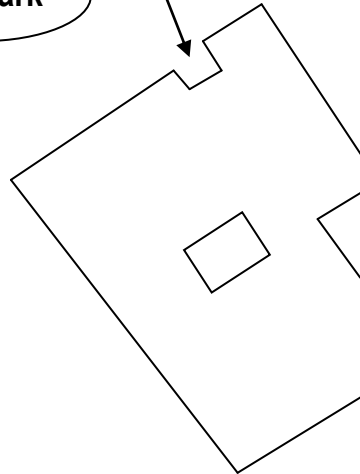

Richardson Wing – Room 2 - 3

www.website.com